

# TECHNICAL SPECS & GENERAL TERMS AND CONDITIONS 2024 MUZENZAAL



## GENERAL INFO

<b>Venue</b>	<b>MUSIS - Muzenzaal</b>
<b>Address (Stage door)</b>	Velperbuitensingel 23 6828 CV Arnhem Netherlands <a href="http://www.musisenstadstheater.nl">www.musisenstadstheater.nl</a>
<b>Phone number</b>	<b>+31 (0)26 3720 710</b>
<b>At day of the show</b>	+31 (0)6 5074 0211 (local tech crew) +31 (0)6 5074 0194 (banqueting crew)



## CONTACT

<b>Promoter Pop, Jazz &amp; World music</b>	Ralph Roelvink • ralph@musis.nl
<b>Promoter Classical music</b>	Peter van Praagh • peter@musis.nl
<b>Promotor Theatre</b>	Ingrid Scheper • ingrid@musis.nl
<b>Cultural education &amp; participation</b>	Rosalinde Hauwert • rosalinde@musis.nl Evalia Zilverschoon • evalia@musis.nl +31(0)26 3720 715
<b>Production</b>	evenementen@musis.nl +31(0)26 3720 710
<b>Marketing</b>	marketing@musis.nl +31(0)26 3720 721

## ROUTE

Please note that the only way of approaching the venue's loading docks is by taking the one-way street called Eusebiusbuitensingel.

Make sure that once you enter this street, coming from the 'Airborne Plein', you stay in the left lane.

On your left side you will see the large green venue, and after 200 meters, you can drive your truck or coach onto the venue premises. The two loading docks are situated there. On the left side of the docks you will find the artist entrance (stage door).

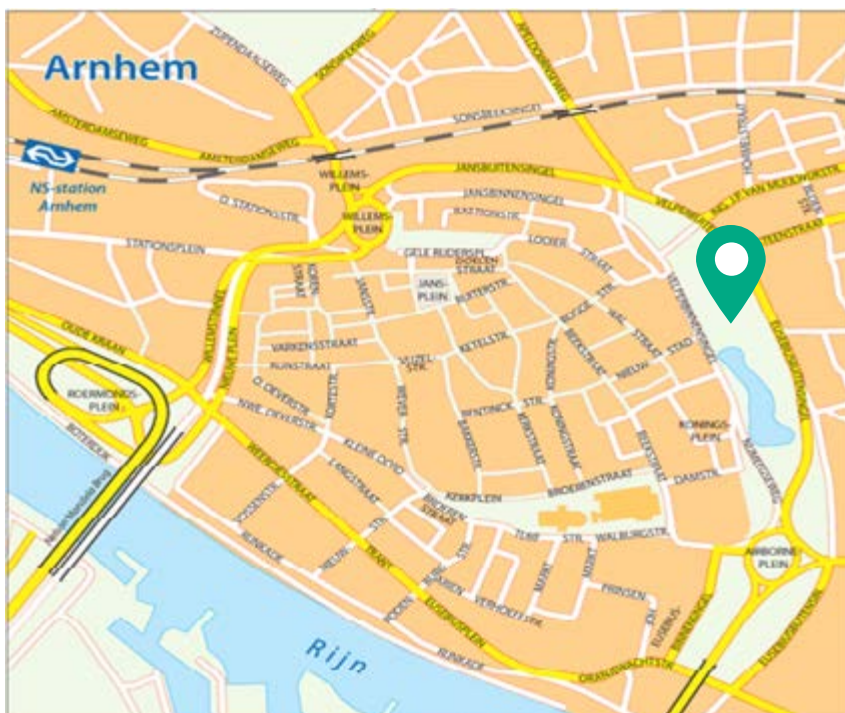

<b>Show information</b>	Please make sure that MUSIS receives all your relevant show information at least three months prior to the date of the show. We need your information in time for the staff planning, equipment and hospitality. We expect you to send us a decent tech rider, stage and lighting plot, along with a hospitality rider. If we do not receive these requirements / this information in full, we will work according to our standard time schedule and no additional requests will be honoured.
<b>Guest list</b>	The guest list has to be mailed to <a href="mailto:evenementen@muis.nl">evenementen@muis.nl</a> one week prior to showday. Each production has a maximum of 10 guests (depending on what's agreed on in the booking agreement) and including those of the support act.
<b>Time schedule</b>	Please respect our timetable, which we shall send you and has to be confirmed by you. No changes can be made one week prior to the show. Due to legal aspects concerning working hours, ticket information and employee costs, agreed upon timetables are not to be exceeded.
<b>Backline</b>	MUSIS does not provide a backline except if agreed upon in our booking agreement. If so, we will rent one, in accordance with your specifications (where possible.)
<b>Included</b>	Included: in both halls; House PA & lights, standard promotion, standard tech crew (incl. 1 stagehand) and Stage & FOH barriers (if required). NOT included: ground transportation, runner, hotels, backline, IEM systems, additional technical requirements not mentioned in our technical specs.
<b>Dinner</b>	If agreed upon in our booking agreements, dinner will be arranged by MUSIS and is in-house, in our downstairs green room (± 120 m <sup>2</sup> - 40 to 50 people). A decent meal will be served, no fast food whatsoever. Vegetarian or vegan options will be provided according to the catering rider of the artist. We need your information 14 days prior to the day of the show, along with information about allergies and other dietary wishes. If there are no agreements to provide dinner, please contact Production for more information. MUSIS has a full equipped professional kitchen. If you would like to use our kitchen please contact the production team in advance for terms and conditions.
<b>Prohibited</b>	Use of pyrotechnics / open fire / flames / special fx is only allowed with a Dutch license, which has to be approved by our production team, one month prior to the show. Use of confetti, streamers or silly strings is not allowed!
<b>Smoking</b>	It is not permitted to smoke inside MUSIS. There are fire alarms in all areas, an alarm will result in complete evacuation. When the alarm is the result of the artist and/or artist's crew smoking in MUSIS, the agreed payment or fee will not be made to the artist.
<b>Merchandise</b>	If you bring your own merchandiser, please contact the banqueting manager on the day of the show for best spot and loading instructions.
<b>Local crew</b>	1x sound technician 1x lighting technician 1x stagehand
<b>Security</b>	We don't have our own security employees. At request we can hire security-staff from one of our professional partners. We use a full barrier line at front stage with standing shows.

<b>Parking</b>	<p>We have two loading docks with dock levellers and 5 parkingspots (cars) for two halls. Please check with our production team for details concerning how many you may use on the day of the show. The stage manager will inform you on the day of arrival what the best solution is for both parties. There is 2x 32A 3-phase CEE-form for nightliners and trucks.</p> <p>There are several public parking garages located around our venue at walking distance.</p>
<b>Internet/Wi-Fi</b>	<p>We have a secured and free wireless internet connection throughout the building.</p> <p>Wi-Fi: Musis - Password: available on request</p>
<b>Dressing rooms</b>	<p>MUSIS has seven dressing rooms for two halls. Four small dressing rooms including a shower and toilet are situated on stage level. Three large dressing rooms (two with a shower and toilet) are situated in the basement. All dressing rooms are lockable and are furnished with tables, chairs, mirrors, adequate lighting and power outlets.</p> <p>If we have an event in both halls at the same time, our production team will make a division in the dressing rooms, as close as possible to the artist's wishes in the hospitality rider.</p>
<b>Photographer</b>	<p>Musis has an in-house photographer, who will take promotional pictures without flash, and only during the first three songs of the show, unless otherwise stated.</p>

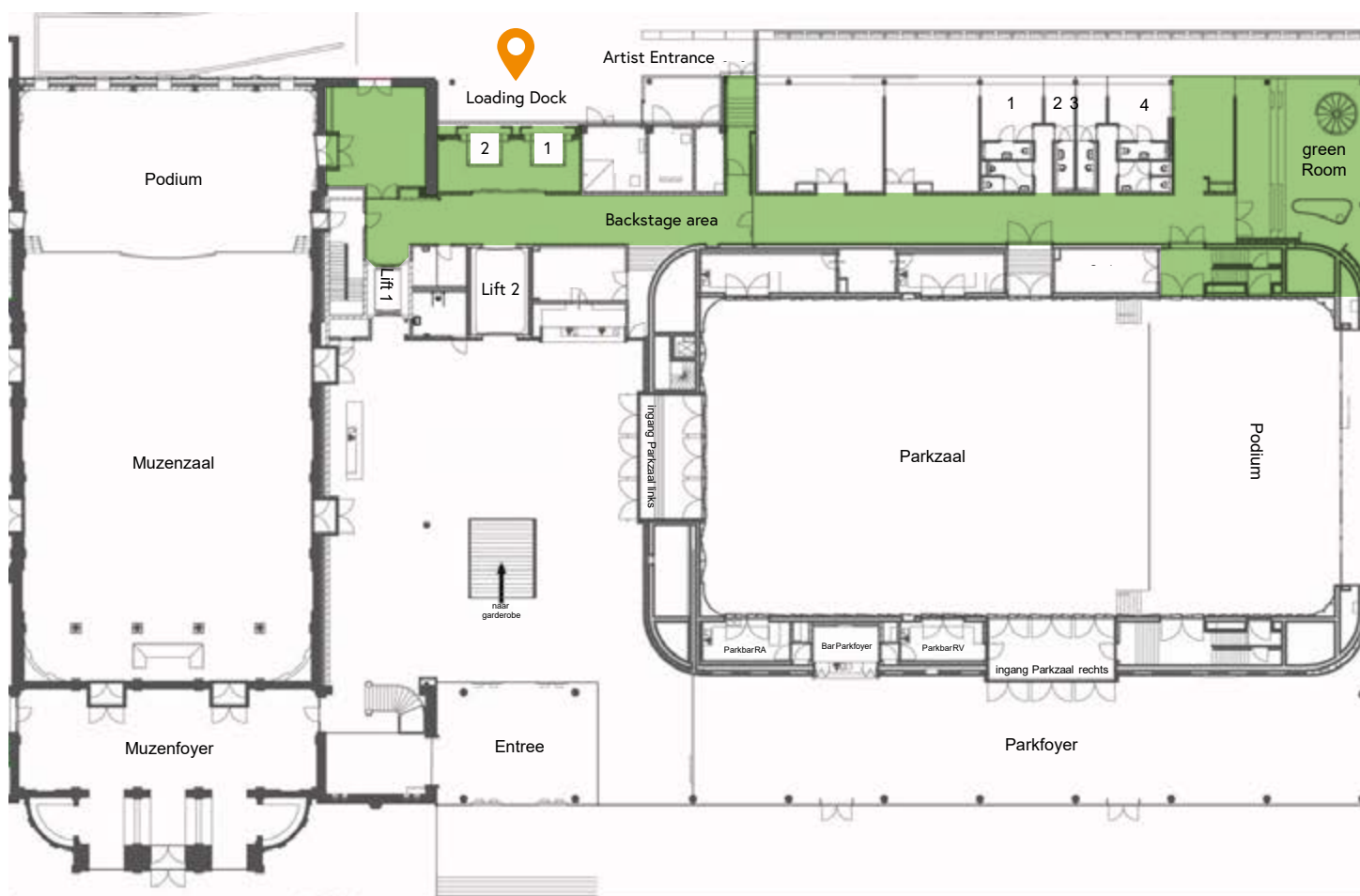

## MUZENZAAL - SPECS GENERAL

<b>Capacity</b>	Seated: 480 - balcony: 265 – standing 915 (balcony excluded)
<b>Stage size</b>	17 m width x 10 m depth - height 1 m
<b>Clearance</b>	10 meters
<b>Hall size</b>	18 m width x 26 m depth
<b>Stage doors</b>	height 2,25 m - width 1,60 m
<b>Loading docks</b>	height 2,45 m - width 2,95 m Distance between loading dock and stage is 15 meters
<b>Aerial lifts</b>	1x ALP lift PHCI 1050 - vertical mast lift – working height maximum 10,50 m 1x Dingli AWP 14 - vertical mast lift - working height maximum 14 m
<b>Risers</b>	16x risers 1 m x 2 m Height: 20, 40, 60 & 80 cm Wood colour surface. 12x risers 1 m x 2 m Height: 20, 40, 60 & 80 cm Black colour surface.
<b>Marley</b>	15 meters width 9 meters depth
<b>Grand Drape</b>	None available. Or possible.
<b>Legs</b>	We have one leg per stage side available. Max 4 meters width 7 meters high.
<b>Back drop</b>	There is no backdrop available in our Muzenzaal, we do have two fixed curtains running along the back and side walls of our stages, Colors options are Black or White.
<b>FOH Size Standing concerts</b>	4 meters width 3 meters depth or made with mojo barriers by standing concerts 3 meters width 4 meters depth
<b>Power supply (sound &amp; lighting)</b>	Stage left: 1x 32A 3 phase (CEE form) - 2x 63 3 phase (CEE form) Stage right: 1x 32A 3 phase (CEE form) - 1x 125A 3 phase (CEE form) Backline power 230V, no converters available
<b>Rigging</b>	Flybar 1 – distance from centre stage 1,8 meter Flybar 2 – Distance from centre stage 3.6 meter Flybar 3 – Distance from centre stage 7.9 meter Maximum weight is 500 kg uniformly distributed. Maximum point load at the steel cable is 150 kg. Maximum centre point load between two steel cables is 100 kg. Note; Our flybars are equipped with a fixed light set.  Above the audience are 5 x 12 m Prolite trusses, each truss mounted on two 500 kg Chain hoists. Maximum weight is 400 kg uniformly distributed. In addition for the theatre setup is a triangle truss mounted that can carry 300 kg uniformly distributed. Just in front of the stage is 1 x 16 m Prolite truss mounted on three 500 kg chain hoist. Maximum weight is 310 kg uniformly distributed. Above each side balcony hangs one 1 x 14 m Prolite truss mounted on two 250 kg chain hoist. Maximum weight is 250 kg uniformly distributed. All instructions by our technical crew must be followed at all times. Please respect our policy, thanks in advance.
<b>Projection</b>	We have a fixed projector in our Muzenzaal. When you have the need for another kind of projecting we can provide a Epson EB-L1505 UH with multiple lens options; ELPL M15 – ELPL W06 - ELPL LU04 – ELPL X02 When needed please contact our production team.
<b>Projection screens</b>	Stump rear or front projection 16:9 630 x 363 cm size 610 x 343 cm image size
<b>Cyclorama (Cyc)</b>	No cyclorama.
<b>Grand pianos</b>	1x Yamaha C5 1x Steinway concert D (serial number D 587044)

### TECHNICAL SPECS & GENERAL TERMS AND CONDITIONS 2024

# MUZENZAAL

## MUZENZAAL - TIME SCHEDULE

14:00	Get in / load in crew
16:30	Get in artist(s)
17:00	Soundcheck
18:00	Dinner break
19:00	Final adjustment
19:00	Doors venue
19:45	Doors Muzenzaal
20:00	SHOWTIME
22:00	End of show
00:00	Curfew (dressing rooms and load out)

## MUZENZAAL - TIME SCHEDULE **MATINEE**

09:00	Get in / load in crew
11:00	Get in artist(s)
11:30	Soundcheck
12:30	Dinner break
13:30	Final adjustment
13:30	Doors venue (at standing shows the Parkzaal opens at the same time)
14:15	Doors Parkzaal at seated shows
14:30	SHOWTIME
16:00	End of show
18:00	Curfew (dressing rooms and load out)

## GOOD TO KNOW

<b>Local emergency number</b>	In The Netherlands the emergency number is: <b>112</b> Apart from Dutch, they also speak English and German.
<b>Nearest doctor</b>	The nearest doctor is situated opposite the artist entrance, on the other side of the road. Medar dokterspraktijk Velperbuitensingel 15a 6828CV Arnhem. +31(0)26 - 351 0990
<b>Nearest drugstore</b>	The nearest drugstore is situated opposite the artist entrance, at the other side of the road. Muis Gezondheidscentrum Velperbuitensingel 15a 6828CV Arnhem.
<b>Nearest hospital</b>	The nearest hospital is Rijnstate Ziekenhuis. Wagnerlaan 55 6815 AD Arnhem +31(0)88 005 8888
<b>Local taxi</b>	Taxi Arnhem Centrale 24/7 +31(0)26 - 2 606 606
<b>Coffee</b>	We only serve coffee from Peeze Arnhem. Because we like it the most.
<b>Smile</b>	We always try to start the day with a smile (and coffee), and try to keep it that way throughout the day. Good food, sufficient breaks and great stories will certainly help to do the trick.
<b>Work</b>	We all work here, because we love the job. We hope you do too, so that together we can make your show an absolute smasher.
<b>Mistakes</b>	Even we make mistakes, and to be honest, we are glad we do. It makes us human, so please be gentle, if it happens. We will always do our best to solve it.



Main entrance • Photo: Skip van der Aalst



Muzenzaal Harlem Gospel Choir • *Photo: Guido Roncken*



Muzenzaal Cengiz Oskan • *Photo: Guido Roncken*



Muzenzaal seated - normal setting • Photo: Bart van Hoek



Muzenzaal • Chairs on stalls in Theatre setting





Muzenzaal • Theateropstelling



Muzenzaal • Theateropstelling



Muzenzaal • Theateropstelling



Muzenzaal • Theateropstelling