

TECHNICAL SPECS & GENERAL TERMS AND CONDITIONS 2024 PARKZAAL



GENERAL INFO

Venue	MUSIS - Parkzaal
Address (Stage door)	Velperbuitensingel 23 6828 CV Arnhem Netherlands www.musisenstadstheater.nl
Phone number	+31 (0)26 3720 710
At day of the show	+31 (0)6 5074 0211 (local tech crew) +31 (0)6 5074 0194 (banqueting crew)



CONTACT

Promoter Pop, Jazz & World music	Ralph Roelvink • ralph@musis.nl
Promoter Classical music	Hylke van Lingen • hylke@musis.nl
Promotor Theatre	Ingrid Scheper • ingrid@musis.nl
Cultural education & participation	Rosalinde Hauwert • rosalinde@musis.nl Evalia Zilverschoon • evalia@musis.nl +31(0)26 3720 715
Production	evenementen@musis.nl +31(0)26 3720 710
Marketing	marketing@musis.nl +31(0)26 3720 721

ROUTE

Please note that the only way of approaching the venue's loading docks is by taking the one-way street called Eusebiusbuitensingel.

Make sure that once you enter this street, coming from the 'Airborne Plein', you stay in the left lane.

On your left side you will see the large green venue, and after 200 meters, you can drive your truck or coach onto the venue premises. The two loading docks are situated there. On the left side of the docks you will find the artist entrance (stage door).

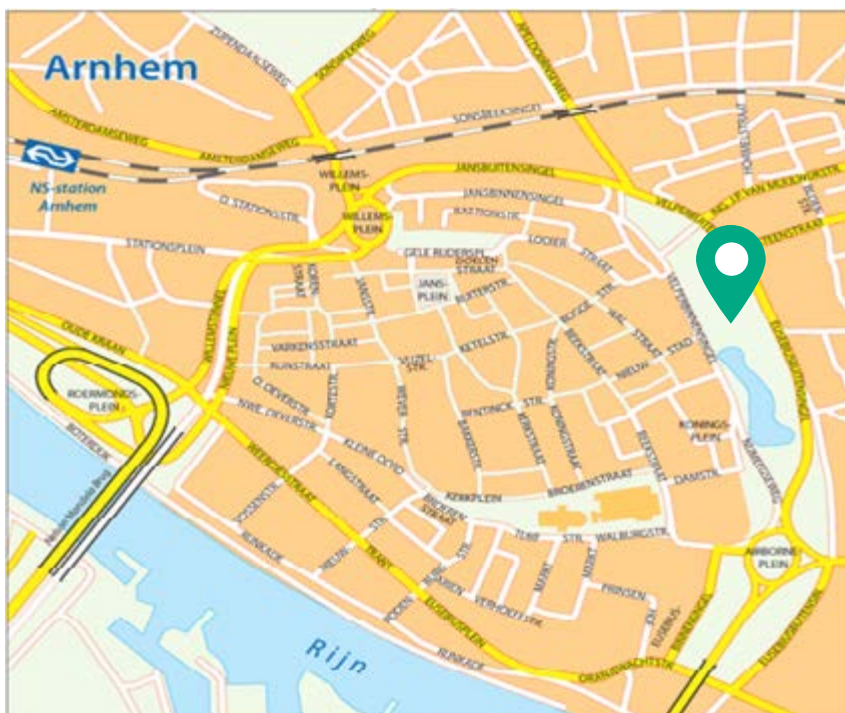

Show information	Please make sure that MUSIS receives all your relevant show information at least three months prior to the date of the show. We need your information in time for the staff planning, equipment and hospitality. We expect you to send us a decent tech rider, stage and lighting plot, along with a hospitality rider. If we do not receive these requirements / this information in full, we will work according to our standard time schedule and no additional requests will be honoured.
Guest list	The guest list has to be mailed to evenementen@musis.nl one week prior to showday. Each production has a maximum of 15 guests (depending on what's agreed on in the booking agreement) and including those of the support act.
Time schedule	Please respect our timetable, which we shall send you and has to be confirmed by you. No changes can be made one week prior to the show. Due to legal aspects concerning working hours, ticket information and employee costs, agreed upon timetables are not to be exceeded.
Backline	MUSIS does not provide a backline except if agreed upon in our booking agreement. If so, we will rent one, in accordance with your specifications, (where possible.)
Included	Included: in both halls; House PA & lights, standard promotion, standard tech crew (incl. 1 stagehand) and Stage & FOH barriers (if required). NOT included: ground transportation, runner, hotels, backline, IEM systems, additional technical requirements not mentioned in our technical specs.
Dinner	If agreed upon in our booking agreements, dinner will be arranged by MUSIS and is in-house, in our downstairs green room (± 120 m ² - 40 to 50 people). A decent meal will be served, no fast food whatsoever. Vegetarian or vegan options will be provided according to the catering rider of the artist. We need your information 14 days prior to the day of the show, along with information about allergies and other dietary wishes. If there are no agreements to provide dinner, please contact Production for more information. MUSIS has a full equipped professional kitchen. If you would like to use our kitchen please contact the production team in advance for terms and conditions.
Prohibited	Use of pyrotechnics / open fire / flames / special fx is only allowed with a Dutch license, which has to be approved by our production team, one month prior to the show. Use of confetti, streamers or silly strings is not allowed!
Smoking	It is not permitted to smoke inside MUSIS. There are fire alarms in all areas, an alarm will result in complete evacuation. When the alarm is the result of the artist and/or artist's crew smoking in MUSIS, the agreed payment or fee will not be made to the artist.
Merchandise	If you bring your own merchandiser, please contact the banqueting manager on the day of the show for best spot and loading instructions.
Local crew	1x sound technician 1x lighting technician 1x host & rigging technician 1x stagehand
Security	We don't have our own security employees. At request we can hire security-staff from one of our professional partners. We use a full barrier line at front stage with standing shows.

Parking	<p>We have two loading docks with dock levellers and 5 parkingspots (cars) for two halls. Please check with our production team for details concerning how many you may use on the day of the show. The stage manager will inform you on the day of arrival what the best solution is for both parties. There is 2x 32A 3-phase CEE-form for nightliners and trucks.</p> <p>There are several public parking garages located around our venue at walking distance.</p>
Internet/Wi-Fi	<p>We have a secured and free wireless internet connection throughout the building. Wi-Fi: Musis - Password: available on request</p>
Dressing rooms	<p>MUSIS has seven dressing rooms for two halls. Four small dressing rooms including a shower and toilet are situated on stage level. Three large dressing rooms (two with a shower and toilet) are situated in the basement. All dressing rooms are lockable and are furnished with tables, chairs, mirrors, adequate lighting and power outlets.</p> <p>If we have an event in both halls at the same time, our production team will make a division in the dressing rooms, as close as possible to the artist's wishes in the hospitality rider.</p>
Photographer	<p>Musis has an in-house photographer, who will take promotional pictures without flash, and only during the first three songs of the show, unless otherwise stated.</p>

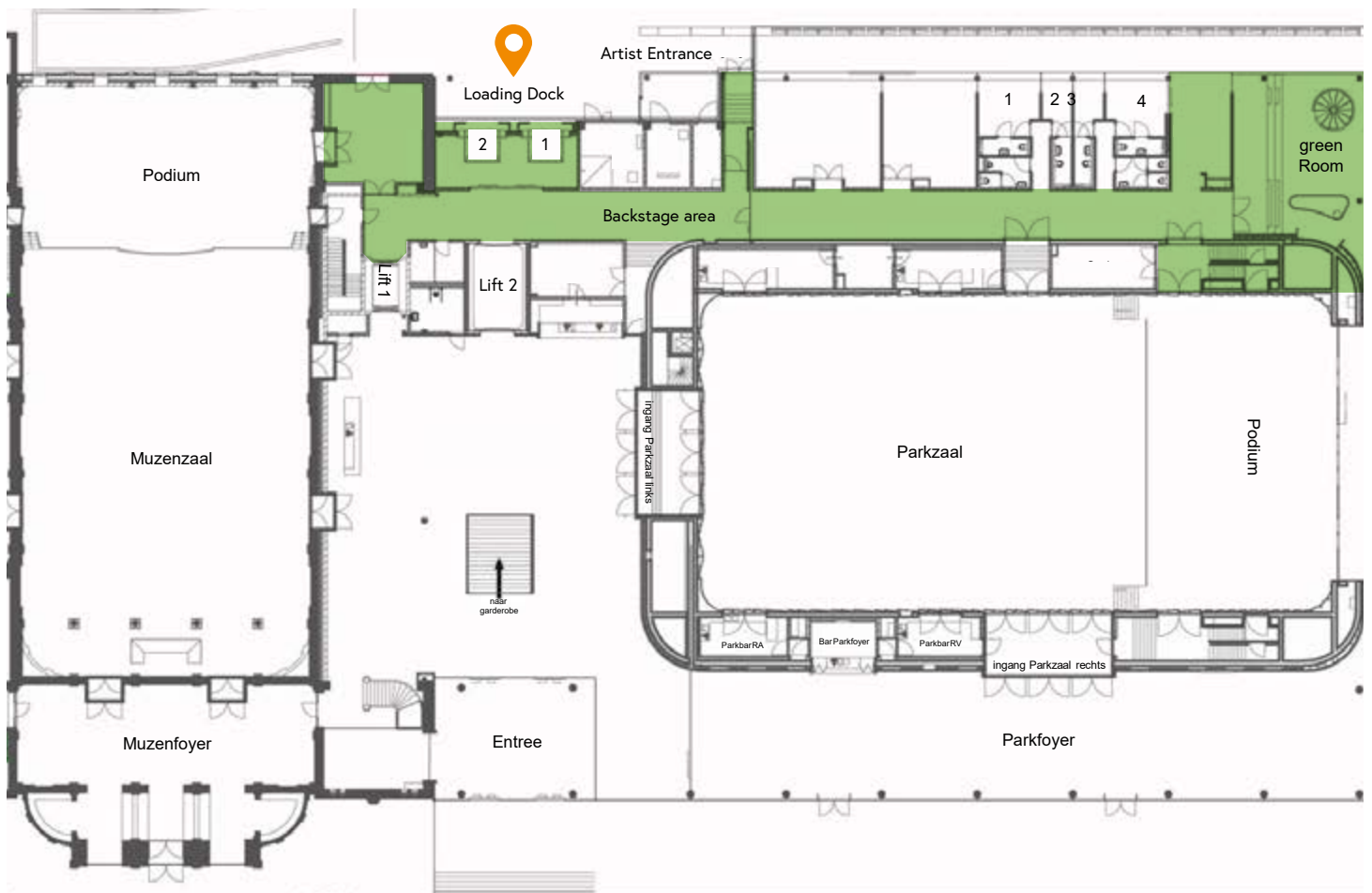

PARKZAAL - SPECS GENERAL

Capacity	Seated: 700 - balcony: 255 - standing 1800
Stage size	16 m width x 12 m depth - height 1 m / standing concerts 1,5 m
Stage safety Standing concerts	With standing concerts we have a full Mojo Barrier line in front of our stage distance between stage and mojo barriers is 0,8 m.
Clearance	11 meters
Hall size	20 m width x 28,8 m depth
Stage doors	Height 2,5 m - width 1,95 m
Loading docks	Height 2,45 m - width 2,95 m Distance between loading dock and stage is 30 meters
Aerial lifts	1x ALP lift PHCI 1050 - vertical mast lift – working height maximum 10,50 m 1x Dingli AWP 14 - vertical mast lift - working height maximum 14 m
Risers	16x risers 1 m x 2 m Height: 20, 40, 60 & 80 cm Wood colour surface. 12x risers 1 m x 2 m Height: 20, 40, 60 & 80 cm Black colour surface.
Marley	16 meters width 10 meters depth
Grand Drape	None available. Or possible.
Legs	We have one leg per stage side available. Max 4 meters width.
Back drop	We have a full stage size black backdrop. 16 meters width.
FOH Size Standing concerts	We can provide two sizes options: <ul style="list-style-type: none">• 4 meters width 3 meters depth• 3 meters width 4 meters depth. Please contact our production team which FOH size you prefer. FOH is secured with mojo barriers.
Power supply (sound & lighting)	Stage left: 1x 16A 3 phase - 1x 32A 3 phase - 1x 63A 3 phase (Audio) – 1x 125A 3 phase Stage right: 1x 16A 3 phase - 1x 32A 3 phase - 1x 63A 3 phase – 1x 125A 3 phase Backline power 230V, no converters available
Projection	Fixed position; Epson EB-L1750U 15000 lumen projector. Flexible position; Epson EB-L1505 UH 12000 lumen projector. Lens options: ELPL M15 – ELPL W06 ELPL LU04- ELPL X02. *When needed please contact our production team.*
Projection screens	Stump rear or front projection 6m x 4 m.
Cyclorama (Cyc)	16 m cyclorama or 12 m horizon available.
Grand pianos	1x Yamaha C5 1x Steinway concert D (serial number D 587044)

PARKZAAL - SPECS GENERAL

The stage

The stage can be used in different heights. Note that the stage left and stage right entrance are fixed at one meter.

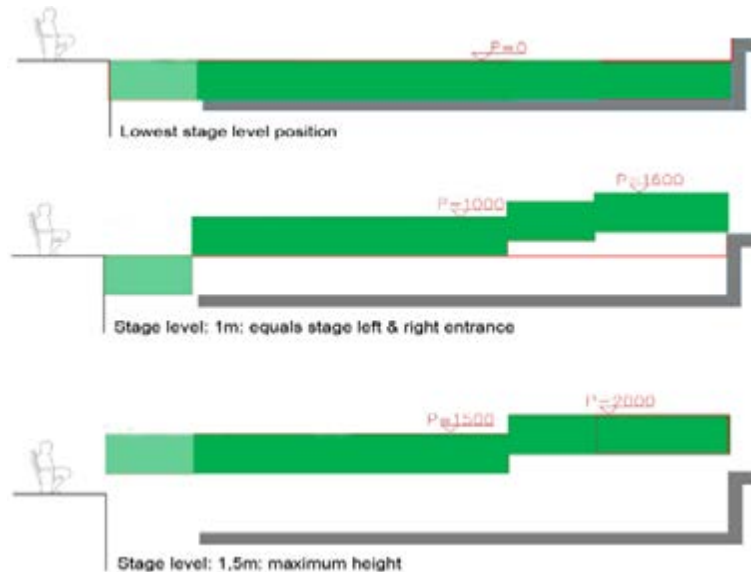

Rigging

Fly Bars:

We have 10 flybars available above stage. (ASM HCWA TwinMasters)
Maximum weight is 450 kg uniformly distributed.

Chain Hosts :

Above stage are 24 chain hoists, maximum load capacity of 250 kg each. (ASM OTTO 250) In between the stage and the audience is a 8 m Prolyte truss mounted on two 500 kg chain hoists (ASM OTTO 500), maximum weight is 800 kg uniformly distributed. The Fly Bars and Chainhost above stage are controlled by a CD2XL Desk.

Above the audience are two Prolyte trusses each mounted on four 500 kg chain hoists. Position of the trusses is adjustable.
Maximum weight is 1350 kg uniformly distributed.

There are 2 drawings to inform you about the positions of fly bars en chain hosts.
All instructions by our technical crew must be followed at all times. Please respect our policy, thanks in advance.

Load specs Fly Bar

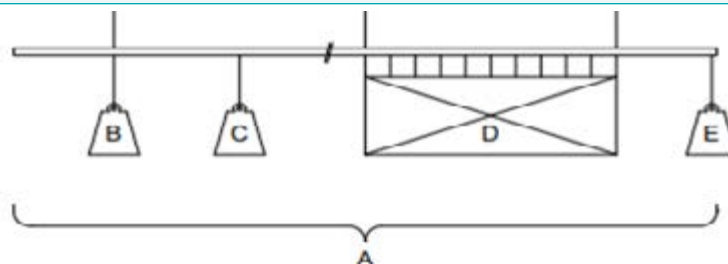

Type	A Totaallast	B Puntlast onder kabel	C Puntlast tussen kabels	D Verdeelde last tussen kabels	E Puntlast uiteinde trek
Trek	450 kg	230 kg	230 kg	230 kg	150 kg
Takel	250 kg	-	-	-	-

Deze besturing en hijsinstallatie voldoen aan UC4 volgens de NEN-EN17206_2018

PARKZAAL - TIME SCHEDULE

13:00	Get in / load in crew
16:30	Get in artist(s)
17:00	Soundcheck
18:00	Dinner break
19:00	Final adjustment
19:30	Doors venue (at standing shows the Parkzaal opens at the same time)
20:15	Doors Parkzaal at seated shows
20:30	SHOWTIME
22:30	End of show
00:00	Curfew (dressing rooms and load out)

PARKZAAL - TIME SCHEDULE **MATINEE**

09:30	Get in / load in crew
11:30	Get in artist(s)
12:00	Soundcheck
13:00	Dinner break
14:00	Final adjustment
14:00	Doors venue (at standing shows the Parkzaal opens at the same time)
14:45	Doors Parkzaal at seated shows
15:00	SHOWTIME
16:30	End of show

GOOD TO KNOW

Local emergency number	In The Netherlands the emergency number is: 112 Apart from Dutch, they also speak English and German.
Nearest doctor	The nearest doctor is situated opposite the artist entrance, on the other side of the road. Medar dokterspraktijk Velperbuitensingel 15a 6828CV Arnhem. +31(0)26 - 351 0990
Nearest drugstore	The nearest drugstore is situated opposite the artist entrance, at the other side of the road. Muis Gezondheidscentrum Velperbuitensingel 15a 6828CV Arnhem.
Nearest hospital	The nearest hospital is Rijnstate Ziekenhuis. Wagnerlaan 55 6815 AD Arnhem +31(0)88 005 8888
Local taxi	Taxi Arnhem Centrale 24/7 +31(0)26 - 2 606 606
Coffee	We only serve coffee from Peeze Arnhem. Because we like it the most.
Smile	We always try to start the day with a smile (and coffee), and try to keep it that way throughout the day. Good food, sufficient breaks and great stories will certainly help to do the trick.
Work	We all work here, because we love the job. We hope you do too, so that together we can make your show an absolute smasher.
Mistakes	Even we make mistakes, and to be honest, we are glad we do. It makes us human, so please be gentle, if it happens. We will always do our best to solve it.



Main entrance • Photo: Skip van der Aalst



Parkzaal exterior



Opening Parkzaal • Photo: Rob Vos



Concert seated - Danny Vera • Photo: Jake Warren



Concert standing - KARSU • Photo: Guido Roncken



Theatre setting - Tribune at Parkzaal



Theatre setting - View from director/technician

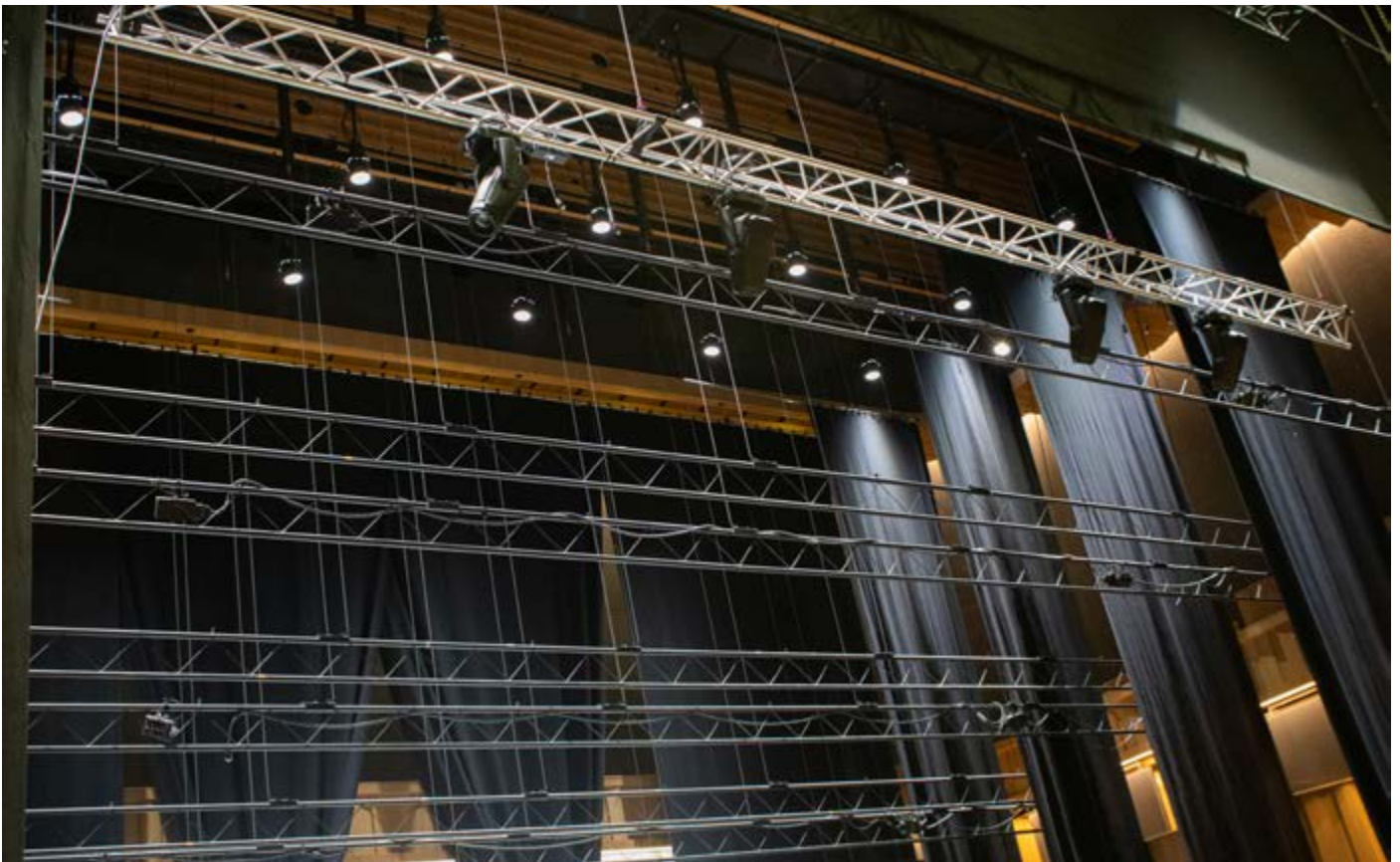

Theatre setting - Rigging Parkzaal



Theatre setting - Grandstand Parkzaal